

MODEL SS-41
Stainless Steel
Flange Adaptor
ANSI 125/150



- For use in services up to 2000kPa
- Investment Cast 316S/S
- Sizes from 50-200mm

Nominal Size DN	Pipe OD mm	Max. Working Pressure* KPa	Max. End Load KN	Dimensions			Sealing Surface		Bolts Size No. mm
				A	B	C	D	E	
50	60.3	2100	5.4	152	121	21	60	87	4 - M16 x 75
65	73.0	2100	7.9	178	140	22	73	102	4 - M16 x 75
80	88.9	2100	11.8	190	152	24	89	116	4 - M16 x 75
100	114.3	2100	19.5	229	191	24	114	141	8 - M16 x 75
150	168.3	1400	30.7	279	241	25	168	198	8 - M20x 90
200	219.1	1400	52.0	343	298	28	219	254	8 - M20x 90

* Based on Sch. 10S pipe.

*Nominal Size: OneSteel/Shurjoint couplings and fittings are identified by nominal diameter of the pipe (DN) in millimetres.

*Pipe OD: Actual outside diameter of the pipe is in millimetres.

* Technical data for pressure ratings and roll grooving of stainless steel pipe please refer to document - B-16 Jun 09 "Pressure Ratings of Ductile Iron and Stainless Steel couplings on Stainless Steel Pipe "

*Working Pressure (Cold Water Pressure) and End Load are total, from all internal and external loads, based on schedule 40S, Sch 10 & Sch 5 Stainless Steel Pipe to ASME B36.19 Welded & Seamless Dimensions and Mass as listed in OneSteel Stainless Steel Pipe brochure (reference document 065 Sep 02).

*WARNING: FOR ONE TIME FIELD TEST ONLY, the Maximum Joint Working Pressure may be increased to 1.5 times the figure shown in table.

*WARNING: Piping systems must always be depressurized and drained before attempting disassembly and or removal of any components.

*OneSteel reserves the right to change specification, designs and/or standard equipment without notice and without incurring any obligation.

Features

- Hinged joint for easy assembly over roll groove
- Holes are incorporated into the fitting suitable for ANSI 125/150 flanges
- Pressure ratings vary depending on schedule and size
- Made to ASTM A-743 – Housing 316 S/S

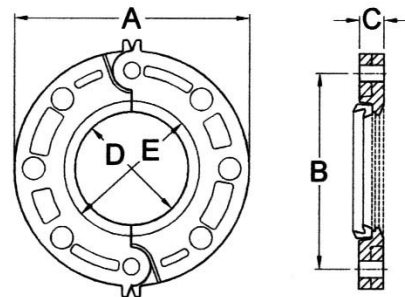



Shurjoint has over three decades of experience and is recognised as a world leader in the design and manufacturer of mechanical piping system components. Shurjoint manufactures the highest quality products by continually investing in research, engineering and development, which enables them to develop new and innovative solutions for the changing needs of industry.

OneSteel Building Services is a specialist trade supplier of pipe, valves and fittings to the fire protection and mechanical services markets in the building construction industry. As a national segment focused business, OneSteel Building Services is uniquely placed to deliver both local and national solutions to customers across Australia.

With specialist teams in each capital city, our strength is in our technical capability and expertise to provide product and application support to mechanical contractors, Plumbers, Sprinkler Fitters, Fabricators, Pump Manufacturers and EPCM customers (Engineering, Procurement and Construction Management).

OneSteel Building Services has proven ability and long-term experience in serving the fire protection and mechanical services markets and we intimately understand the urgent nature of the building industry. We know it is important to be responsive, value our customer relationships and ensure our service is speedy, reliable and convenient.

OneSteel Piping Systems is one of Australia's leading product and service providers of pipe, valves and fittings in the resources, construction, manufacturing and energy markets. We Partner with key customers in oil and gas, mining and engineering construction, offering customised solutions with our superior range of piping systems products and national service capability.

Our dedicated personnel bring industry experience and technical capability that enables us to work closely with clients to add value to our relationships and maximise customer satisfaction.

By sourcing domestically and internationally, OneSteel Piping Systems is experienced in connecting our customers with some of the most recognised brands for pipe, valves and fittings. We have long standing relationships with some of the world's leading valve manufacturers and import a comprehensive range of pipe and fittings. This is in addition to our locally manufactured pipe from Australian Tube Mills and OneSteel Oil & Gas Pipe.

As a specialist supplier to many industries, OneSteel Piping Systems offers a complete package. Whether it's a project, application advice or next day delivery for a piping system product anywhere in Australia, OneSteel has the solution.

National:		1300 553 473
Adelaide:	70 Grand Junction Road, Kilburn SA	08 8304 7570
Brisbane:	Unit 5, 429 Creek Road, Mt Gravatt QLD	07 3420 4099
Melbourne:	90 Turner Street, Port Melbourne VIC	03 8645 3222
Perth	1 Howson Way, Spearwood WA	08 9494 0989
Sydney	49 Elizabeth Street, Wetherill Park NSW	02 8788 5810

This information is provided for your assistance. However we are obliged to draw your attention to the following: OneSteel provides the information contained in this brochure as a guide only for your information. OneSteel has taken reasonable care to ensure the accuracy of the material but you should not rely on the whole or any part of the information. OneSteel expressly disclaims all liability whatsoever for (including any direct or indirect loss or damage, costs or expenses howsoever incurred by any person) or reliance on the whole or any part of the information contained in or omitted from this brochure. OneSteel recommends that you verify any information regarding products with your independent expert adviser and rely solely on that adviser's recommendations.

